

## PRD10913 MONITOR TFT 7" 12-24V 3CAM COLOR LOCKED KEYS DATASHEET



### DESCRIPTION

The ACTIA TFT monitors are designed to meet automotive requirements and have specific functions for entertainment and surveillance applications on buses, trucks, trains, vans, trailers and other commercial vehicles.

### FEATURES

- Supports 3 AHD cameras with a maximum resolution of 1080P.
- Remote control.
- Multiple video formats:  
PAL/NTSC/HDAHD/HDTV/HDCVI (720P/1080P).
- High resolution TFT LCD.
- Compact and innovative design.
- Easy installation in security system.
- Wide operating voltage range 10VDC ~ 32VDC.

	By	Date	MONITOR TFT 7" 12-24V 3CAM COLOR LOCKED KEYS	Ref. ACTIA	Index
Draw	C.Conrado	10/14/20		PRD10913	Rev00
Rev.	M.Franceschi	10/14/20			
Appr.	C.Dambroz	10/14/20			Page 1/12

## TECHNICAL DATA

PARAMETER	VALUE
LCD Screen Size	7"
LCD Screen Resolution	1024x600
Anti-reflective LCD Screen	No
Supply Voltage	10VDC ~ 32VDC
Maximum Power Consumption	< 8W (@24VDC)
Standby Power Consumption	< 1,2W (@24VDC)
Operating Temperature	-20°C ~ +70°C, HR 90%
Storage Temperature	-30°C ~ +80°C, HR 90%
Video System	PAL / NTSC
Pixel Pitch	0.1506mm (H) x 0.1432mm (V)
Contrast Ratio	800:1
Luminance	600 cd/m <sup>2</sup>
Viewing Angle	U: 85°/ D: 85°, R/L: 85°/ 85°
Screen Response Time (maximum)	25ms
Display Colors	16.777.216
Color Depth	24 bits
Aspect Ratio	16:9
Protection Fuse	Yes
Number of Speakers	1
Speaker Power	1W
Video Inputs (cameras)	3
Video Signals Type	TVL, AHD 720P/30, AHD 1080P/30
Audio Inputs	3
Number of Triggers	3 (activated by VDC)
Dimensions	184mm x 122mm x 28.7mm
Monitor Weight	415,55g
Connection Cable Weights	223,14g
Built-in Support Weight	69,79g
Articulated Support Weight	134,82g
Weight Support Sunscreen	27,44g
Remote Control Weight (without battery)	12,18g

**DIMENSIONS**  
*(Millimeters)*

*Front View Monitor 7"*

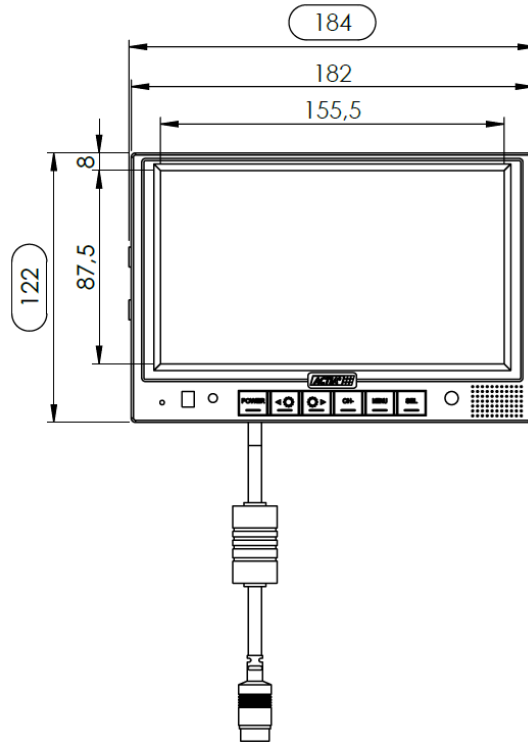

*Rear View Monitor 7"*

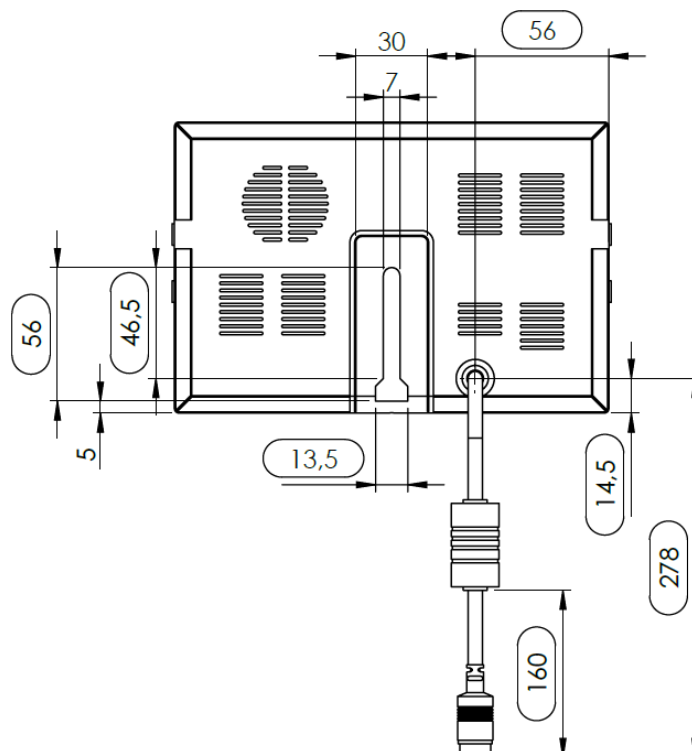

*Side View Monitor 7"*

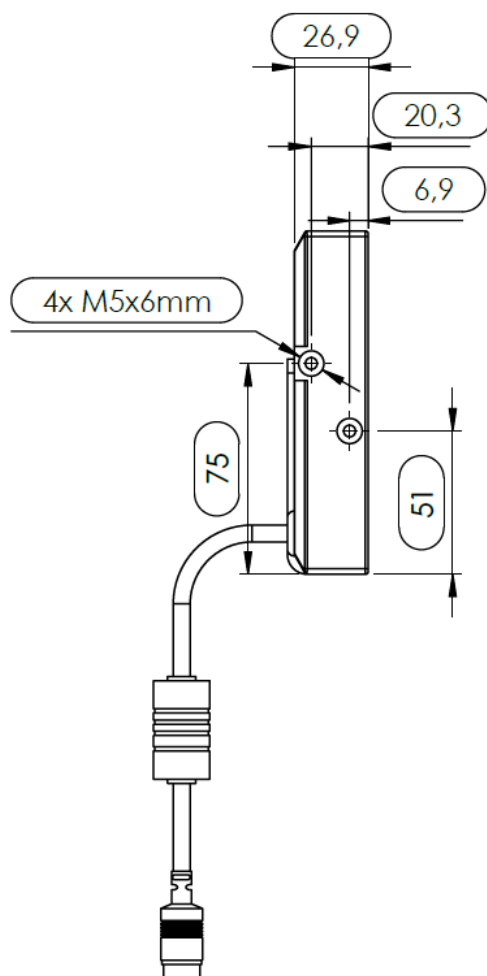

*Bottom View Monitor 7"*

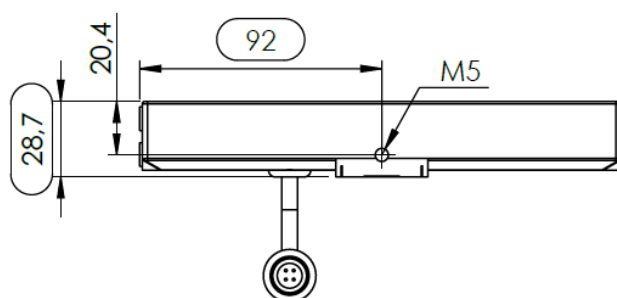

*Rear View Embed Support*

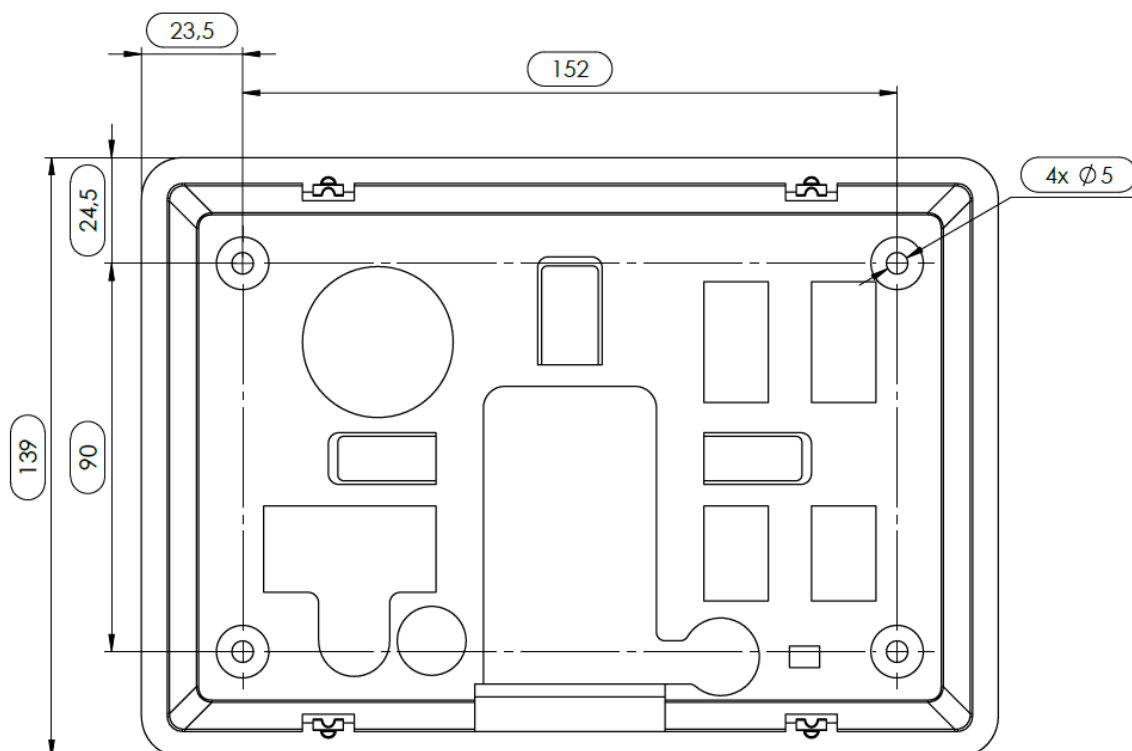

*Top View Embed Support*

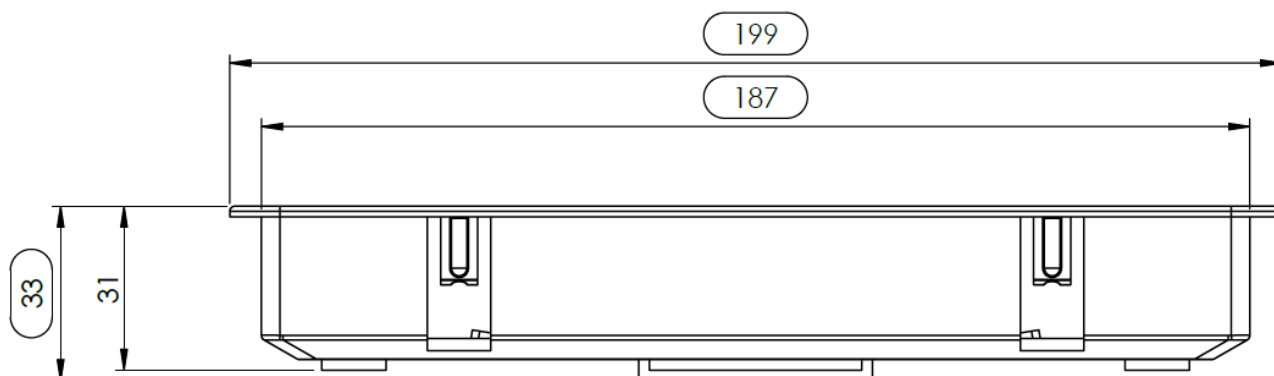

*Top View Articulated Support*

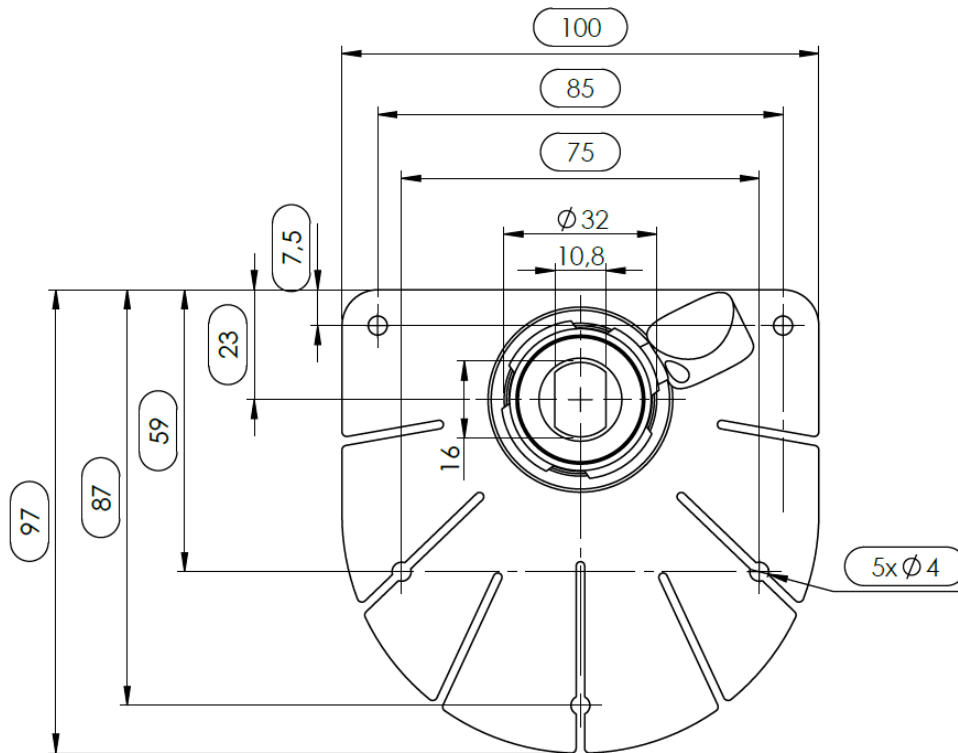

*Side View Articulated Support*

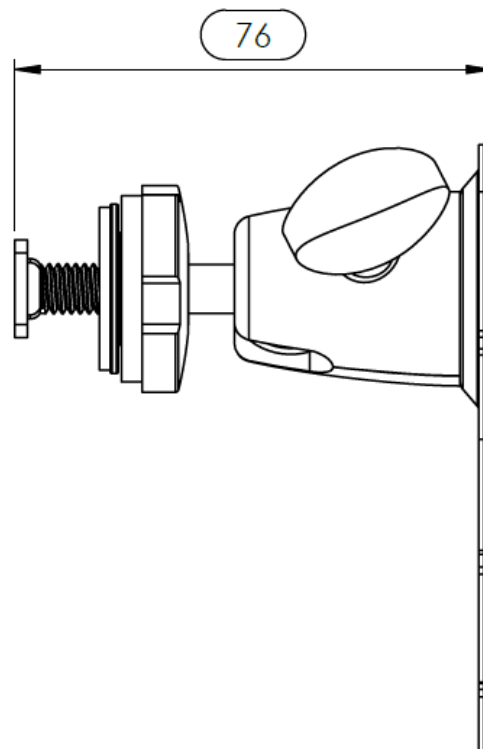

*Front View Sunshade Support*

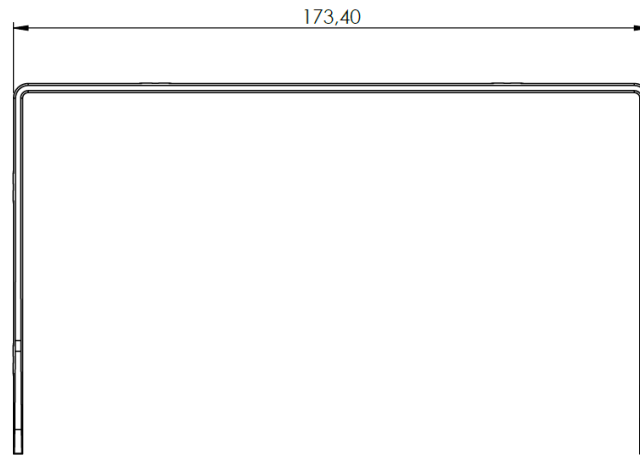

*Side View Sunshade Support*

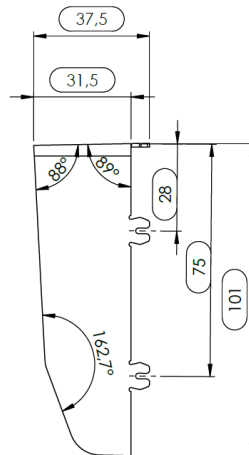

*Top View Sunshade Support*



*Remote Control*



## CABLES AND CONNECTIONS

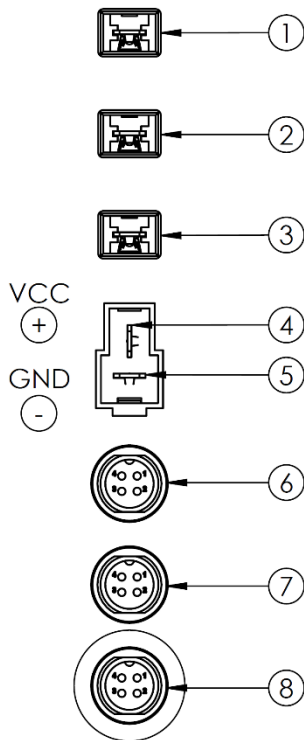
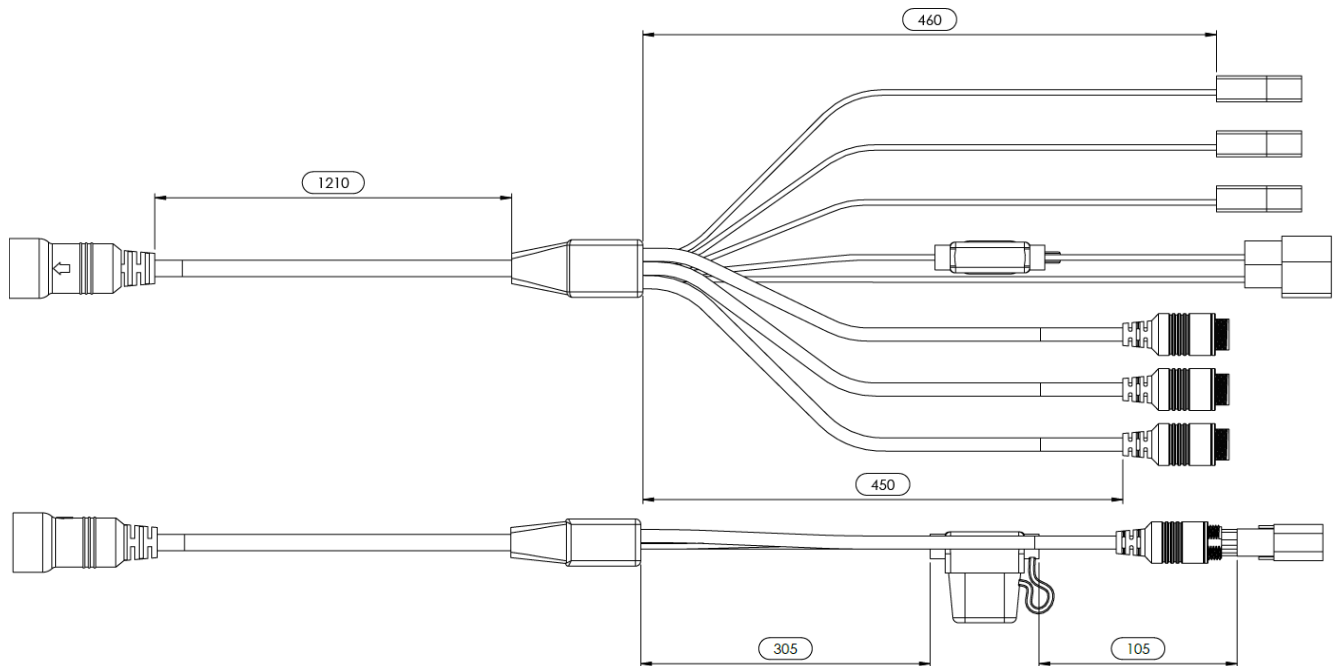

Número Number	Cor Color	Função Function
1	BRANCO	TRIGGER CAM 1
2	AZUL	TRIGGER CAM 2
3	MARROM	TRIGGER CAM 3
4	LARANJA	DC01-32V
5	PRETO	GND
6	BRANCO	CAM 1
7	AZUL	CAM 2
8	MARROM	CAM 3

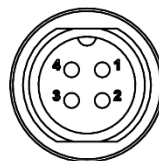

1 - 12V  
 2 - GND  
 3 - ÁUDIO  
 4 - VÍDEO

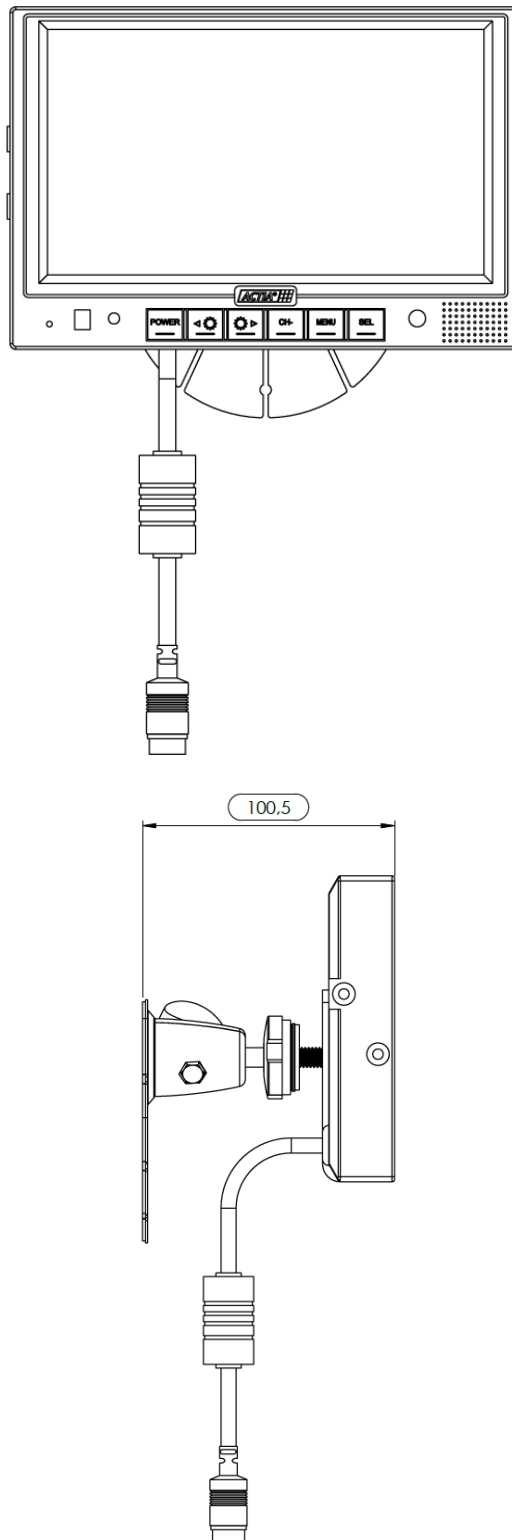

**ASSEMBLY ARTICULATED SUPPORT**

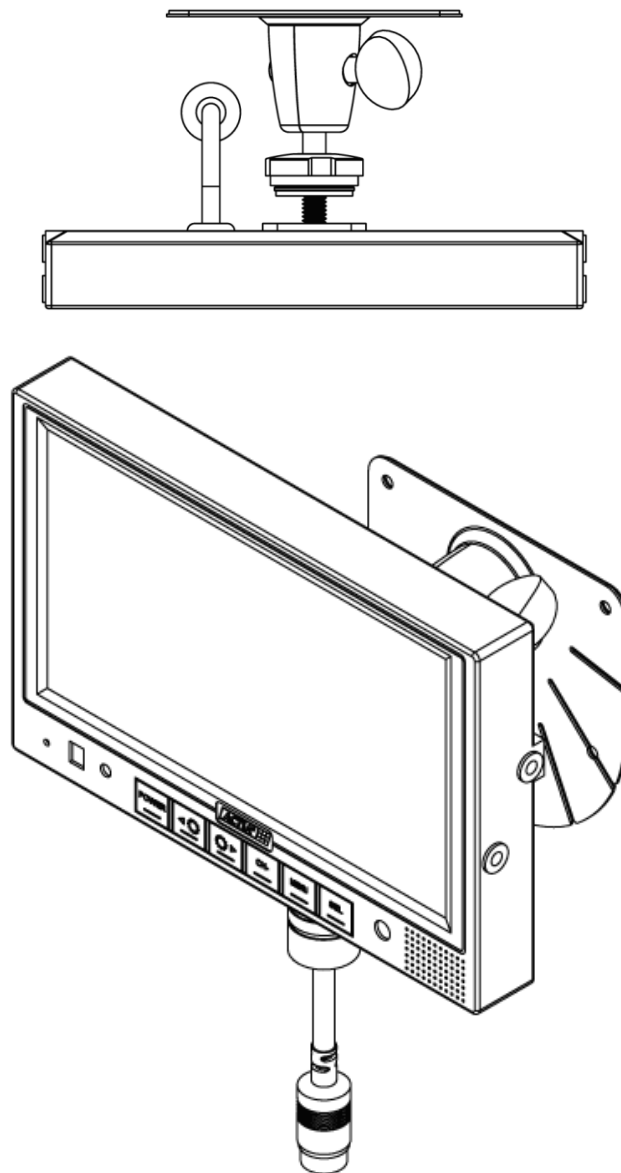

## BUILT-IN BRACKET ASSEMBLY

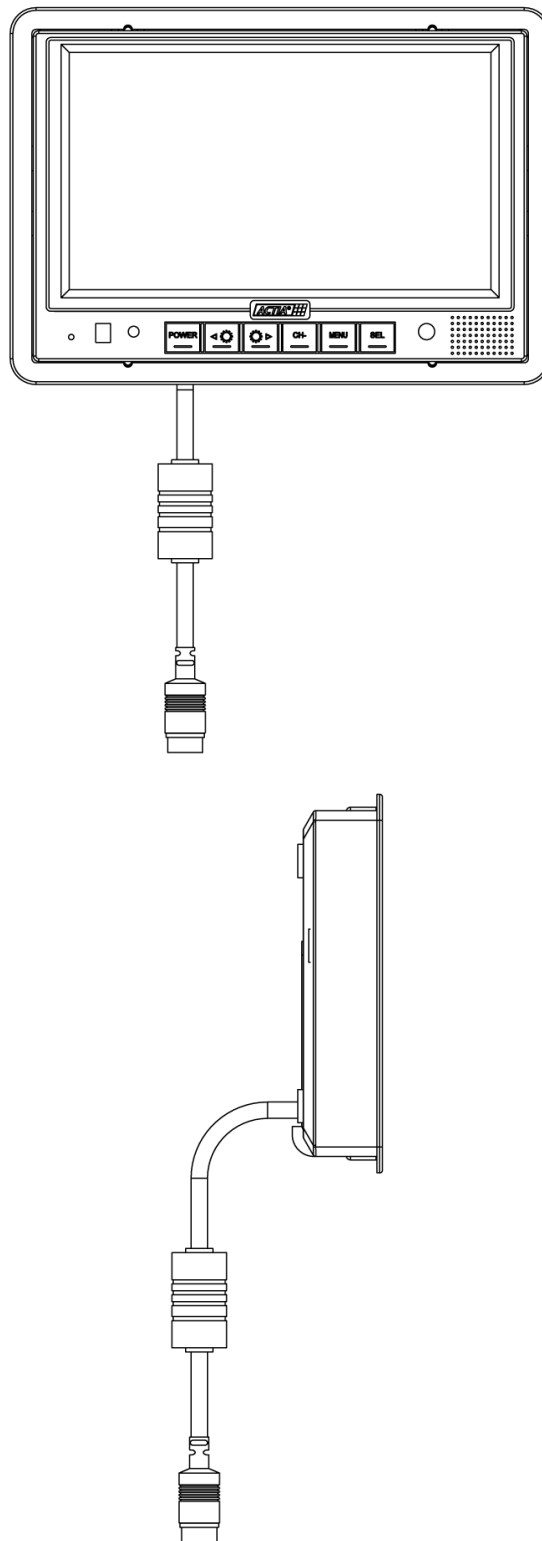

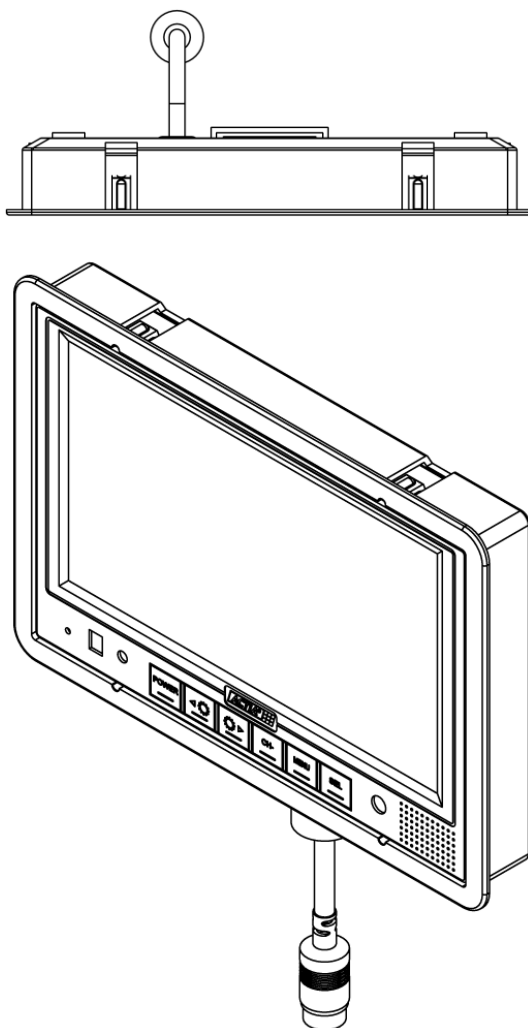

## REVISIONS HISTORY

<i><b>Review</b></i>	<i><b>Date</b></i>	<i><b>Reviewer</b></i>	<i><b>Description</b></i>
00	10/14/20	C.Conrado	Document creation.